



PGIM REAL ESTATE



6500 CLINKER DR, BUILDING 5  
JURUPA VALLEY / CALIFORNIA

A JOINT VENTURE OF CT REALTY  
AND PGIM REAL ESTATE

AVAILABLE FOR  
IMMEDIATE OCCUPANCY

210,004 SF  
(EXPANDABLE UP TO 231,000 SF)

[VIEW WEBSITE](#)

CBRE

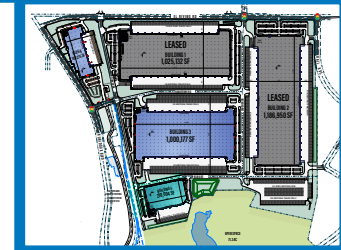
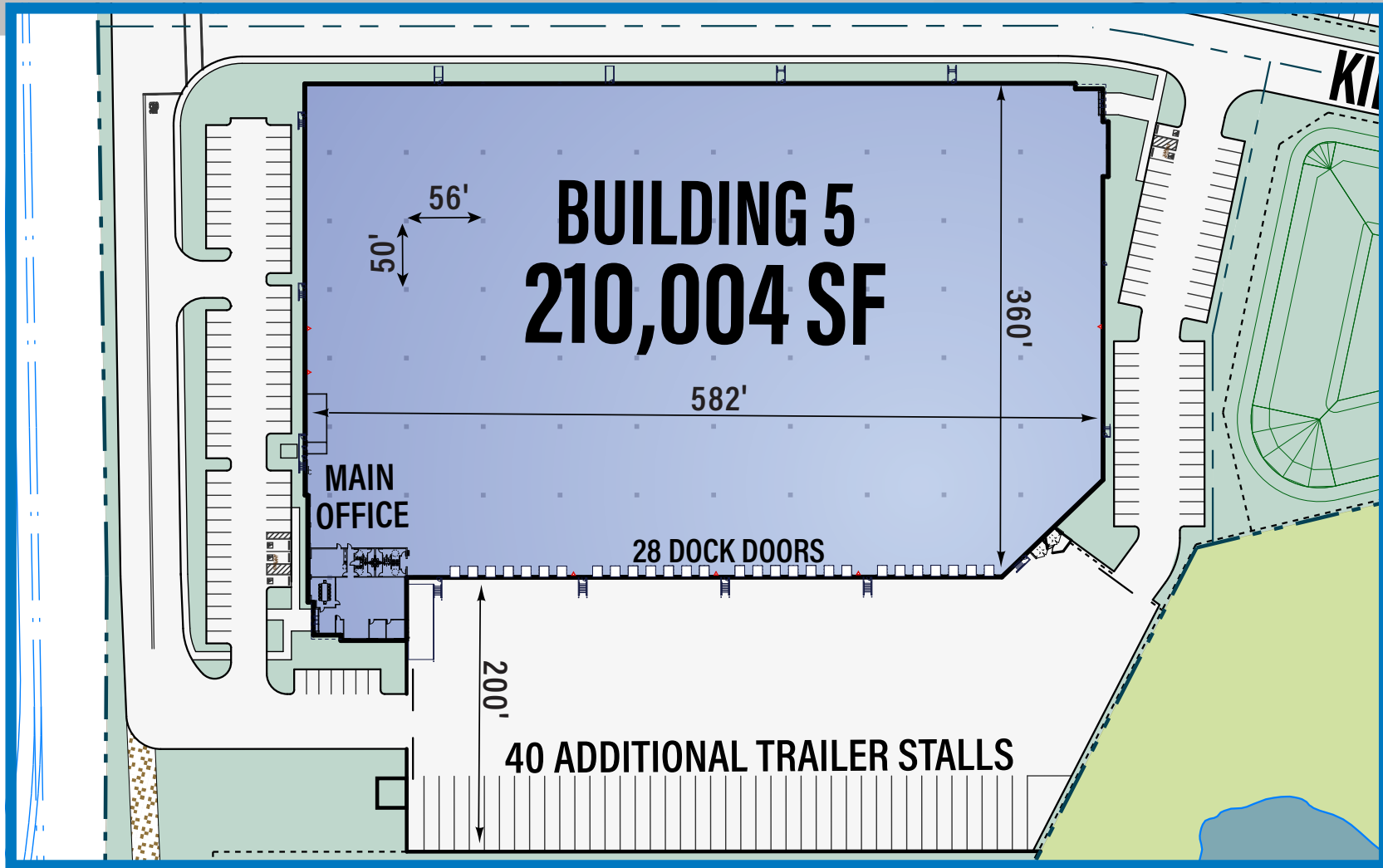

# BUILDING FEATURES

## STATE-OF-THE-ART CONSTRUCTION



**210,004**  
SQ. FT.



**11.69**  
ACRES



**36'**  
CLEAR HEIGHT



**28**  
DOCK HIGH DOORS  
9'W X 10'H

Z-GUARDS AT ALL DOOR JAMBS

40,000 LB MECHANICAL PIT LEVELERS  
ON 14 DOCK DOORS WITH DOCK SEALS  
2 DOCK BUMPERS PER LEVELER &  
DOCK SEALS



**1**

GRADE LEVEL DOORS  
12'W X 15'H

MANUAL CHAIN HOIST  
Z-GUARDS AT ALL DOOR JAMBS



**FORKLIFT  
CHARGING**  
INFRASTRUCTURE  
(12 STATIONS)



**40**  
TRAILER  
PARKING



**127**  
AUTO  
PARKING



**200'**  
TRUCK  
COURT(S)



### LIGHTING

WAREHOUSE LED LIGHTING W/  
EMERGENCY LIGHTING  
EXPANDABLE FOR TENANT'S NEEDS



**4,475 SF**

SPEC OFFICE  
10' CEILING HEIGHT, CONFERENCE ROOM,  
501 SF BREAKROOM, & 2 RESTROOMS



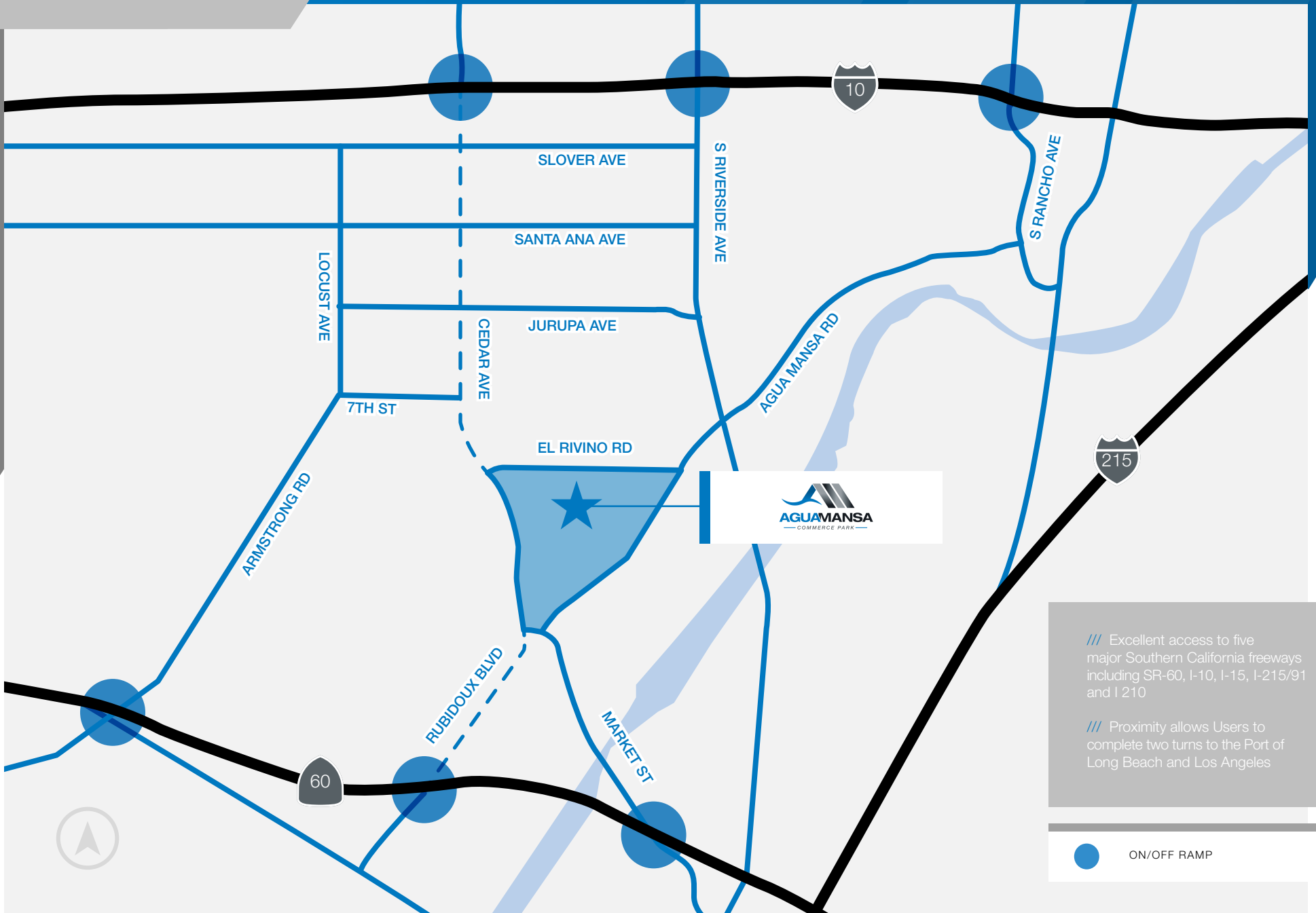

# LOCAL MAP

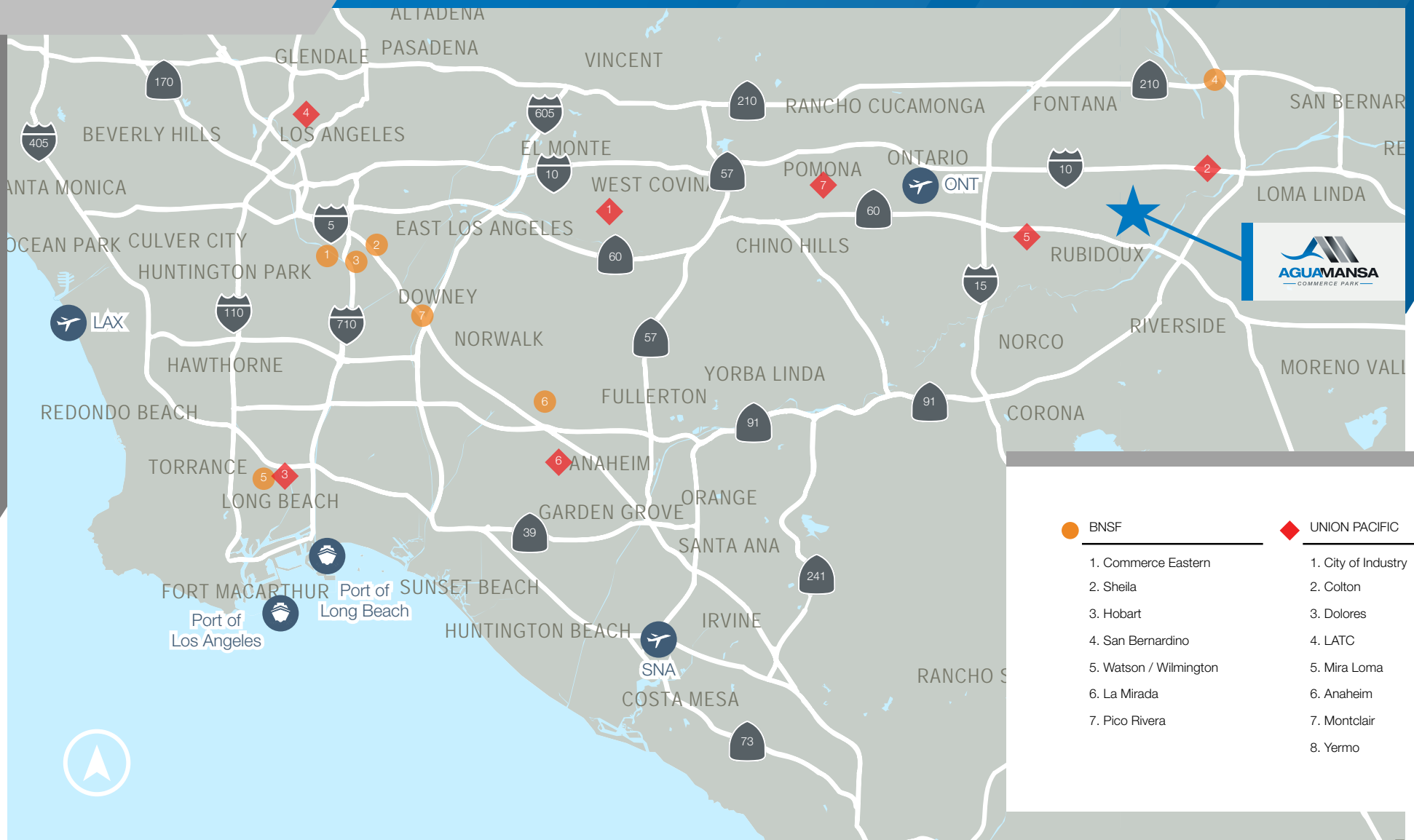

# REGIONAL MAP



- |  |   |
|--|---|
|  BNSF |  UNION PACIFIC |
| 1. Commerce Eastern  | 1. City of Industry   |
| 2. Sheila  | 2. Colton   |
| 3. Hobart  | 3. Dolores  |
| 4. San Bernardino  | 4. LATIC  |
| 5. Watson / Wilmington   | 5. Mira Loma  |
| 6. La Mirada   | 6. Anaheim  |
| 7. Pico Rivera   | 7. Montclair  |
|  | 8. Yermo  |

## KEY DISTANCES



1.5 MILES



2.6 MILES



4.0 MILES



7.6 MILES



SAN BERNARDINO INT'L AIRPORT

12.2 MILES



14.4 MILES



ONTARIO INT'L AIRPORT

15.0 MILES



PORT OF LONG BEACH

62.3 MILES



PORT OF LOS ANGELES

65.2 MILES

# LOCAL TENANTS IN THE AREA



**DAN DE LA PAZ**

Vice Chairman  
Lic. 01233784  
+1 909 418 2169  
dan.delapaz@cbre.com

**JEFF FRITCH**

Senior Vice President  
Lic. 01857956  
+1 909 418 2075  
jeff.fritch@cbre.com

**DARLA LONGO**

Vice Chairman  
Lic. 00639911  
+1 909 418 2105  
darla.longo@cbre.com

**BARBARA PERRIER**

Vice Chairman  
Lic. 00969169  
+1 213 613 3033  
barbara.perrier@cbre.com



[www.AguaMansaCommercePark.com](http://www.AguaMansaCommercePark.com)

© 2024 CBRE, Inc. All rights reserved. This information has been obtained from sources believed reliable but has not been verified for accuracy or completeness. CBRE, Inc. makes no guarantee, representation or warranty and accepts no responsibility or liability as to the accuracy, completeness, or reliability of the information contained herein. You should conduct a careful, independent investigation of the property and verify all information. Any reliance on this information is solely at your own risk. CBRE and the CBRE logo are service marks of CBRE, Inc. All other marks displayed on this document are the property of their respective owners, and the use of such marks does not imply any affiliation with or endorsement of CBRE. Photos herein are the property of their respective owners. Use of these images without the express written consent of the owner is prohibited.

